

COPPER FORK TYPE INSULATED TERMINAL

Material Copper IS : 1897 :: Finished Electro Tinned

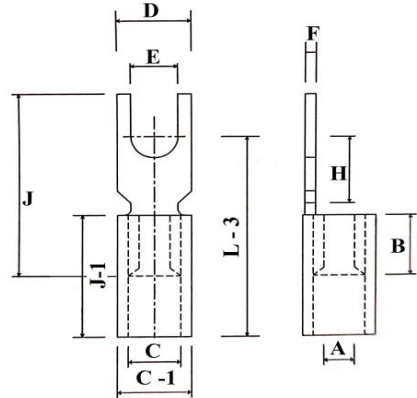
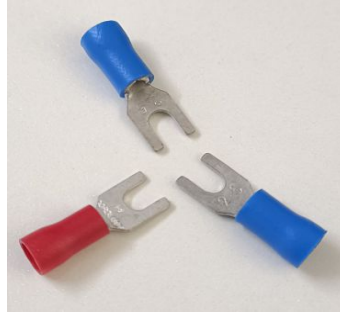

All dimensions in mm

Size mm ²	E	A	C	D	F	B	H	J	C-1	J-1	L-3	CORDLUG CAT NO.
1.5	3.5	1.6	3.2	6.8	0.8	4.0	4.8	13.0	4.8	10.0	20.8	L7926
1.5	3.0	2.0	2.8	6.2	0.8	5.0	3.1	13.0	4.8	10.0	20.5	L7927
2.5	3.5	2.3	3.9	6.5	0.8	5.0	4.3	15.0	5.5	10.0	21.8	L7928
2.5	5.0	2.6	4.6	10.6	1.0	6.2	6.2	21.0	5.5	10.0	20.0	L7929
4.6	3.1	3.5	5.5	6.0	1.0	6.0	5.5	15.0	7.1	14.0	27.5	L7930
4.6	3.5	3.5	5.5	6.0	1.0	6.0	5.0	15.0	7.1	14.0	27.0	L7931
10.0	6.5	4.5	6.9	16.0	1.2	8.0	11.0	27.0	7.9	16.0	35.0	L7932
10.0	8.2	4.5	6.9	16.0	1.2	8.0	11.0	27.0	7.9	16.0	35.0	L7933